

REMOTE CONTROLLER INSTALLATION INSTRUCTION SHEET

(PART NO. 9368991012)

For authorized service personnel only.

⚠ WARNING

(1) For the air conditioner to operate satisfactorily, install it as outlined in this installation instruction sheet.

(2) Installation work must be performed in accordance with national wiring standards by authorized personnel only.

(3) Do not turn on the power until all installation work is complete.

- Let the customer keep this installation instruction sheet because it is used when the air conditioner is serviced or moved.

⚠ CAUTION

(1) Do not wire the bus wire together with or parallel to the indoor and outdoor units connecting wire and power cord. It may cause erroneous operation.

(2) When installing the bus wire near a source of electromagnetic waves, use shielded wire.

(3) Operating methods are the same as normal (1 air conditioner, 1 remote controller). For details, refer to operating manual and installation instruction sheet.

(4) Do not set either the dip switches or the rotary switches, either on the air conditioner or the remote controller, in any way other than indicated in this sheet or the operating manual that is supplied with the air conditioner. Do not change any switch settings in any way other than indicated. Doing so may result in an accident.

1 CENTRALIZED CONTROL

- One remote controller can control up to 16 air conditioners.
- All the air conditioners can be operated with the same setting.

WIRING METHOD

- (1) Wire each air conditioner (power cord-indoor and outdoor units connection cord) individually.
For details, refer to the ELECTRICAL WIRING section of the installation instruction sheet.
- (2) Connect the bus wire between the indoor units to [REMOTE CONTROLLER 2, 3] of the indoor unit terminal board.
- (3) Install the remote controller to only one air conditioner and remove the remote controller of the other air conditioners.

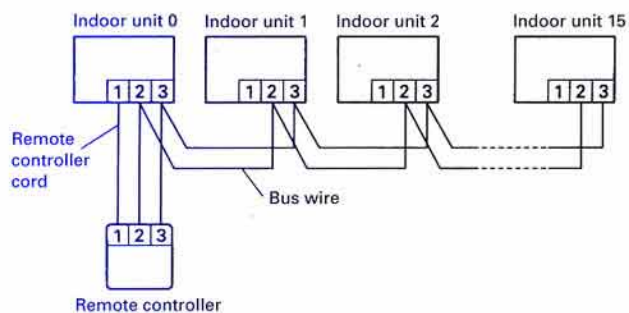

BUS WIRE

- Use wire having a cross sectional area of 0.75mm².
- Make the total length of the bus wire (including the remote controller cord) 500m or less.

- (4) Fasten the bus wire with a binder (large) as shown at the right.

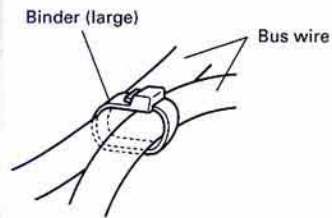

UNIT NO. SETTING METHOD (Performed at indoor unit)

- (1) Remove the electric parts box.
- (2) Turn off the main power.
- (3) Set the unit number with the rotary switch on the indoor unit PC board so it is not duplicated. (Unit No. 0-15)
- (4) After setting the unit number, restore the electric parts box.

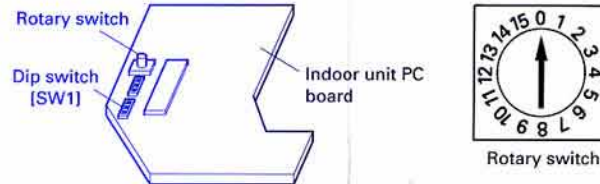

NUMBER OF CONNECTED UNITS SETTING METHOD (Performed at remote controller)

- (1) Remove the remote controller cover.
- (2) Set remote controller Dip switch 1 [6] to [ON]. (Figure at the right)
- (3) Set the number of additional air conditioners with remote controller Dip switch 1 [1-4].
For the number of additional connected units, see the table below.
- (4) Restore the remote controller cover.

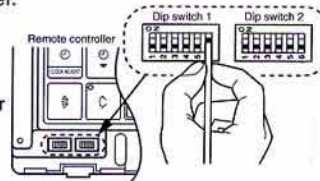

Number of additional air conditioners	Dip switch 1 setting	Number of additional air conditioners	Dip switch 1 setting	Number of additional air conditioners	Dip switch 1 setting
1		6		11	
2		7		12	
3		8		13	
4		9		14	
5		10		15	

CAUTION

- (1) Connect the bus wire between indoor units by wiring it so that the numbers are correct.
- (2) When setting the Rotary switch and Dip switch, do not touch any other parts on the PC board directly with your bare hands.

SELF DIAGNOSIS

- If [E : EE] flashes at the remote controller current time display, perform [Self Diagnosis].
- For the [Self Diagnosis] method, refer to the test operation section of the installation instruction sheet. The faulty air conditioner is also displayed.

Example

[E : 02] Error cord
: 00 Faulty unit No.

: Unit 00 room temperature sensor open

2

ZONE CONTROL

- When the ZONE CONTROL button is pressed while multiple air conditioners are being centralized controlled, only the preset air conditioners stop.
- Set Dip switch 1 [1] of the indoor unit PC board you want to stop by ZONE CONTROL button to [ON]. (Figure at the right)

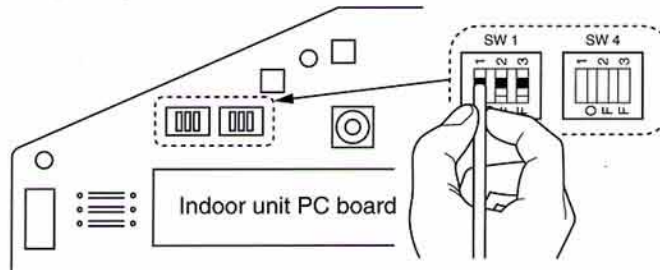

OPERATION CONFIRMATION

- Press the ZONE CONTROL button of the remote controller during centralized control operation. Check if only the set air conditioners stop.
- When the ZONE CONTROL button is pressed again, all the air conditioners operates.

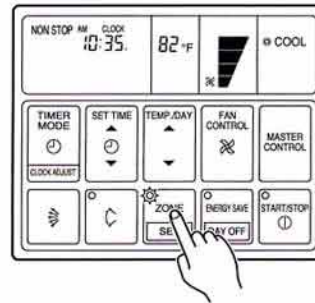

3

AUTO RESTART

- When the air conditioner power was temporarily turned off by a power failure etc., it restarts automatically after the power recovers. (Operated by setting before the power failure)

SETTING METHOD (Performed by remote controller)

- (1) Turn off the main power.
- (2) Set remote controller Dip switch 2 [2], [6] to [ON].

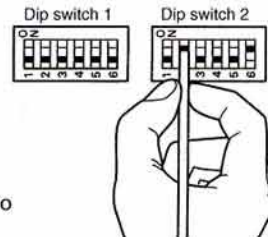

4

MEMORY BACKUP FUNCTION

MEMORY BACKUP FUNCTION

This function starts operation in accordance with the contents before operation was stopped by pressing of the START/STOP button when the power supply to the air conditioner was stopped and restarted by a power failure, switch, etc.

- MEMORY BACKUP FUNCTION use
In the state in which the remote controller case top is removed, set Dip switch 2 [6] of the remote controller to the ON position.

