

FUJITSU



World-Class Manufacturing, Design and Engineering.

Fujitsu General Ltd. (FGL), the parent of Fujitsu General America, Inc., continues to pursue excellence in product design and engineering standards of heating and cooling products for both commercial and residential applications. Global production capacity of nearly 2.5 million and existing ventures into emerging cooling technologies assure a dedicated commitment to advanced product development.

Our manufacturing facilities have met ISO 9002 and ISO 14001 international standards that assure reliability and effectiveness. With advanced global procurement of key components, Fujitsu is positioned to stay at the forefront of leading dynamic corporations.

Seasoned in the global proving ground, we continue to meet expanding markets and the demand for high quality, innovative heating and cooling systems. Fujitsu prides itself on its leading market position in North America and throughout the world.



FGL-CORPORATE HEADQUARTERS, JAPAN



LAEM CHABANG, THAILAND



SHANG-HAI, CHINA

TABLE OF CONTENTS

Corporate Profile	2
Halcyon Introduction	3
Halcyon Product Line	4-5
Single-Zone Systems	6-7
Dual-Zone Systems	8-9
Tri-Zone Systems	10
Universal Systems	11
Ceiling Cassette Systems	12-13
Air Flow Technology	14
Digital Wireless Remotes	14
Product Comparison Chart	15
Warranty and Additional Info	15

For more information
please visit our website at
www.fujitsugeneral.com



THE POWER TO CALM THE WIND™

For 30 years, we have been working hard to make the world a more comfortable place. We have produced and shipped millions of air conditioning systems throughout the world to make the hottest places cool and the coolest places comfortable.

As one of the top three mini-split air conditioner and heat pump manufacturers for North America, Fujitsu's innovation drives the success of the Halcyon line.

These products have been designed to provide zoned comfort for residential and commercial applications. Engineered to install quickly and easily without ductwork, Halcyon systems provide preferred cooling and heating solutions where others cannot.

Halcyon by Fujitsu is a new way to think about air conditioning in the modern world. Now you can choose a high performance, permanent and easy to install air conditioning system that quietly blends with your environment.



Halcyon Product Line

Halcyon mini-split systems are a quiet and non-intrusive ductless solution for cooling and heating in the home or business. Because a mini-split is comprised of an indoor and outdoor unit, this allows for a quieter and peaceful inside environment by enabling your contractor to install louder components like compressors and motors outdoors.

Copper tubing running through a small 3-inch opening in the wall or ceiling easily connects the indoor and outdoor units. Refrigerant is cycled through the lines from the outdoor condensing unit to the indoor air handler, where the air is quietly distributed to the interior space.

FEATURES AND BENEFITS

- Ease of installation.
- Simple zone control for increased comfort and efficiency.
- Remote controls easily adjust indoor climates in multiple zones of your home or business.
- Reduced system energy losses because distribution takes place through insulated refrigeration lines rather than ductwork.

SINGLE-ZONE SYSTEMS

Air Conditioners

Perfect for controlling hard to cool areas for both residential and light commercial buildings.

Conventional air duct systems tend to be bulky and can require special structural attention while Halcyon system piping can often be routed through walls and joists to maintain aesthetics.

Installation is as simple as 1, 2, 3...

1. Mount indoor and outdoor units.
2. Connect the refrigerant lines.
3. Make a few electrical connections.

An easy installation for your contractor saves you time and money.

- Aesthetics are improved over window units and no windows need to be blocked.
- Smart environmental control through Artificial Intelligence Technology. The use of microcomputers enables our products to think and respond to changing conditions, allowing carefree operation and optimum comfort.

Heat pumps

Excellent technology for supplemental heating and cooling applications.



DUAL-ZONE SYSTEMS

Fujitsu's dual-zone system allows for two separate rooms to be cooled simultaneously yet independently through one connection to a single, outdoor condensing unit. It's like having two systems in one.



TRI-ZONE SYSTEM

Independent Operation: This tri-zone system enables the user to modify three environmental zones independently, or simultaneously.



CEILING SUSPENDED SYSTEM

The cost-effective, attractive way to control any indoor climate, where wall space is limited and fresh air is needed.



UNIVERSAL SYSTEM

Approach various comfort conditioning problems with a flexible system that can be suspended from the ceiling, or placed low on the wall or floor.



CEILING CASSETTE SYSTEMS

An ideal alternative for areas with limited wall space or low ceilings. Recessed above a suspended ceiling, cassettes provide a flush mounting that blends with any décor.



Single-Zone Systems

Fujitsu brand ductless air conditioners can be used to solve various application-specific problems. Businesses and institutions such as schools, churches, nursing homes and hospitals, commercial office buildings, strip malls, motels and restaurants, apartments and condos, computer and telephone switching rooms, and even residences commonly use these systems. With more efficient zone control, “ductless mini-splits” are perfect for renovations, restorations, conversions, and add-ons.

ADDITIONAL AND EXCEPTIONAL FEATURES

- **Auto Restart/Reset:** In the event of a temporary power failure, these systems will automatically restart in the same operating mode as before once the power has been restored.
- **Auto Louver Function:** This feature enhances the air distribution by enabling the user to automatically set a gentle, “air sweep” motion in various patterns from the remote control. A vertical louvered motion for systems 9C1, 9R1, 12C1 and 12R1, and a “dual louvered” function for systems 18C1, 18R1, 24C1, 24R1 and 30C1 provide vastly improved air flow.
- **Power Diffuser:** An additional feature triggered by the maximum auto louver function has been created with the “power diffuser.” This additional louver opens based on our AI technology (Artificial Intelligence) monitoring sensors to quickly enhance immediate comfort needs.
- **Dry Mode:** This setting helps to control humidity levels when cooling may not be needed.
- **Sleep Function:** This feature automatically adjusts the temperature while you sleep to make you more comfortable. Smaller models also incorporate an extra “Quiet” fan speed to be sure you are not disturbed.
- **Moderate Low Ambient Operation:** This additional feature allows the systems to operate indoors, even when outdoor ambient temperatures are 32°F, without any additional accessory.
- **Energy Saver Mode:** The Fujitsu system “energy saver” mode allows the unit to keep your room cool enough for comfort by using a relaxed thermostat setting, automatically reducing power consumption (Systems 18C1/18R1/24C1/24R1/30C1).
- **Auto Change-Over:** This feature provides a functional change from cooling to heating or vice-versa automatically depending on the desired temperature set and functional requirement. Auto Change-Over monitor operation range is $\pm 4^{\circ}\text{F}$ relative to the set temperature (Systems 9R1A/12R1A/18R1/24R1).

AIR CONDITIONING SYSTEMS 9C1, 12C1 HEAT PUMP SYSTEMS 9R1A, 12R1A



AIR CONDITIONING SYSTEMS 18C1, 24C1 HEAT PUMP SYSTEMS 18R1, 24R1



AIR CONDITIONING SYSTEM 30C1



AIR CONDITIONERS

HEAT PUMPS

	AIR CONDITIONERS				HEAT PUMPS													
	9C1	12C1	18C1	24C1	30C1	9R1A	12R1A	18R1	24R1									
Nominal Cooling <i>BTU/h</i>	9,400	12,200	18,000/17,000	23,000/22,500	29,500/28,700	9,400	11,800	17,500/16,500	23,000/22,500									
Nominal Heating <i>BTU/h</i>	—	—	—	—	—	10,800	14,000	18,000/17,500	23,500/22,500									
HSPF <i>BTU/hW</i>	—	—	—	—	—	7.2	7.2	6.8	6.8									
SEER	11.0	11.0	11.0	10.5	10.0	10.5	10.5	10.5	10.5									
Moisture Removal <i>P_t/h(l/h)</i>	2.9 (1.4)	3.8 (1.8)	4.2/4.0 (2.0/1.9)	5.7/5.3 (2.7/2.5)	9.1 (4.3)	2.1 (1.0)	3.2 (1.5)	3.8/3.6 (1.8/1.7)	6.4/6.1 (3.0/2.9)									
Voltage/Frequency/Phase	115/60/1	115/60/1	230/208/60/1	230/208/60/1	230/208/60/1	115/60/1	115/60/1	230/208/60/1	230/208/60/1									
Recommended Fuse Size <i>#</i>	15	20	20	20	30	15	20	20	20									
Air Circ. <i>c.f.m. (m³/h) : Hi</i>	300 (510)	306 (520)	470 (800)	648 (1,100)	648 (1,100)	300 (510)	312 (530)	470 (800)	648 (1,100)									
<i>Medium</i>	271 (460)	282 (480)	412 (700)	560 (950)	560 (950)	271 (460)	282 (480)	412 (700)	560 (950)									
<i>Low</i>	241 (410)	259 (440)	347 (590)	470 (800)	470 (800)	241 (410)	259 (440)	347 (590)	470 (800)									
<i>Quiet</i>	218 (370)	235 (400)	—	—	—	218 (370)	230 (390)	—	—									
Noise Level <i>dB(A) : Hi</i>	40.0	41.0	42.0	48.0	48.0	40.0	41.0	42.0	42.0									
<i>Medium</i>	37.0	39.0	38.0	46.0	46.0	37.0	39.0	38.0	38.0									
<i>Low</i>	34.0	37.0	34.0	42.0	42.0	34.0	37.0	34.0	34.0									
<i>Quiet</i>	32.0	35.0	—	—	—	32.0	35.0	—	—									
Indoor Fan Speed <i>RPM : Hi</i>	1,320	1,350	960	1,260	1,260	1,320	1,350	960	1,260									
<i>Medium</i>	1,210	1,250	840	1,130	1,130	1,210	1,250	840	1,130									
<i>Low</i>	1,100	1,150	720	990	990	1,100	1,150	720	990									
<i>Quiet</i>	1,000	1,050	—	—	—	1,000	1,050	—	—									
Outdoor Fan Speed <i>RPM</i>	795	795	735	735	790	795	795	735	735									
Outdoor Noise Level <i>dB(A)</i>	47.0	47.0	56.0	57.0	57.0	49.0	47.0	56.0	57.0									
Current <i>(A) : Cooling</i>	9.0	11.0	8.3/9.1	10.7/11.7	15.0/16.0	8.8	11.0	8.2/8.9	10.5/11.3									
<i>Heating</i>	—	—	—	—	—	7.8	10.7	8.0/8.5	9.9/10.4									
Power Use <i>(kw) : Cooling</i>	0.95	1.25	1.91/1.89	2.41/2.40	3.15/3.05	0.95	1.24	1.89/1.84	2.34/2.29									
<i>Heating</i>	—	—	—	—	—	0.88	1.21	1.82/1.77	2.18/2.13									
Fan Speeds <i>Stage</i>	4 + Auto.	4 + Auto.	3 + Auto.	3 + Auto.	3 + Auto.	4 + Auto.	4 + Auto.	3 + Auto.	3 + Auto.									
Air Direction : <i>Horizontal</i>	Manual	Manual	Automatic	Automatic	Automatic	Manual	Manual	Automatic	Automatic									
<i>Vertical</i>	Automatic	Automatic	Automatic	Automatic	Automatic	Automatic	Automatic	Automatic	Automatic									
Air Filter	Washable	Washable	Washable	Washable	Washable	Washable	Washable	Washable	Washable									
Front Grille	Removable	Removable	Removable	Removable	Removable	Removable	Removable	Removable	Removable									
Connection Method	Flare	Flare	Flare	Flare	Flare	Flare	Flare	Flare	Flare									
Combined Max. Lgth <i>ft #</i>	49 (15)	49 (15)	98 (30)	98 (30)	98 (30)	49 (15)	49 (15)	65 (20)	65 (20)									
Max. Vertical Diff. <i>ft #</i>	26 (8)	26 (8)	49 (15)	49 (15)	49 (15)	26 (8)	26 (8)	49 (15)	49 (15)									
Conn. Pipe Diameter <i>Inch</i>	Suc. 3/8 Dis. 1/4		Suc. 1/2 Dis. 1/4		Suc. 5/8 Dis. 3/8		Suc. 5/8 Dis. 3/8		Suc. 3/4 Dis. 3/8		Suc. 3/8 Dis. 1/4		Suc. 1/2 Dis. 1/4		Suc. 5/8 Dis. 3/8		Suc. 5/8 Dis. 3/8	
Net Weight <i>lbs. (kg)</i>	20 (9)	64 (29)	20 (9)	75 (34)	40 (18)	145 (66)	40 (18)	147 (67)	40 (18)	207 (94)	20 (9)	66 (30)	20 (9)	77 (35)	40 (18)	147 (66)	40 (18)	150 (68)
Dimensions : <i>Height Inch</i>	11	20-7/8	11	20-7/8	12-19/32	25-3/8	12-19/32	25-3/8	12-19/32	45-11/32	11	20-7/8	11	20-7/8	12-19/32	25-3/8	12-19/32	25-3/8
<i>mm</i>	280	530	280	530	320	643	320	643	320	1152	280	530	280	530	320	643	320	643
<i>Width Inch</i>	32-1/8	29-17/32	32-1/8	29-17/32	49-7/32	33	49-7/32	33	49-7/32	37	32-1/8	29-17/32	32-1/8	29-17/32	49-7/32	33	49-7/32	33
<i>mm</i>	815	750	815	750	1250	840	1250	840	1250	940	815	750	815	750	1250	840	1250	840
<i>Depth Inch</i>	7	9-27/32	7	9-27/32	7-11/16	13-1/4	7-11/16	13-1/4	7-11/16	14-9/16	7	9-27/32	7	9-27/32	7-11/16	13-1/4	7-11/16	13-1/4
<i>mm</i>	179	250	179	250	195	336	195	336	195	370	179	250	179	250	195	336	195	336
	Indoor ASU9C1	Outdoor AOU9C1	Indoor ASU12C1	Outdoor AOU12C1	Indoor ASU18C1	Outdoor AOU18C1	Indoor ASU24C1	Outdoor AOU24C1	Indoor ASU30C1	Outdoor AOU30C1	Indoor ASU9R1A	Outdoor AOU9R1A	Indoor ASU12R1A	Outdoor AOU12R1A	Indoor ASU18R1	Outdoor AOU18R1	Indoor ASU24R1	Outdoor AOU24R1

Additional detail on page 15.



Dual-Zone Systems

With Fujitsu's new line of multi-zone air conditioners and heat pumps you can now do more than you ever thought possible with a conventional A/C system.

Built in features like: Auto Swing Louver, power Diffuser and four fan speeds; help create true Zone Conditioning rather than single room cooling.

With this onboard computer it even knows when to turn on, when to change fan speeds and even when to turn itself off; all to optimize efficiency.

ADDITIONAL AND EXCEPTIONAL FEATURES

- **Removable & Washable Front Grilles:** Due to user friendly design in cosmetic engineering, the front grilles are removable without tools.
- **Independent Operation:** This "dual zone" system comes with two remotes, two independent circuits, and two separate compressors, allowing the user to control multiple zones simultaneously or individually.

DUAL-ZONE AIR CONDITIONING SYSTEMS 18CD, 24CD1 DUAL-ZONE HEAT PUMP SYSTEM 18RD



DUAL-ZONE APPLICATIONS

This illustration shows the flexibility of our "dual zone" system and the space savings gained by having only one condenser for two zones. Installation costs are reduced as well.

When two individual zones have separate functions or comfort requirements, a space saving way to fulfill those requirements is by using a "dual zone" system that has a single outdoor condensing unit.

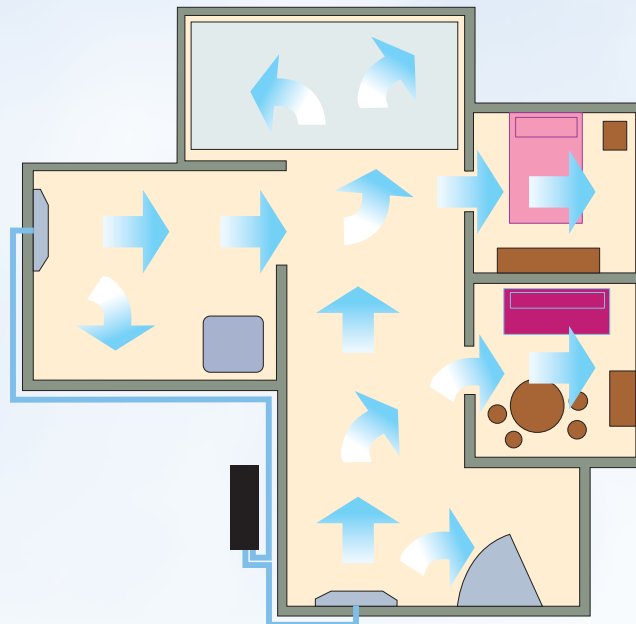

DUAL-ZONE SYSTEMS

	18CD		18RD		24CD1	
Nominal Cooling <i>BTU/h</i>	9,600/9,300	18,800/18,600	9,600/9,300	18,800/18,600	11,500/11,300	23,000/22,600
Nominal Heating <i>BTU/h</i>	—	—	10,700/10,300	21,500/20,500	—	—
HSPF <i>BTU/hW</i>	—	—	—	6.8	—	—
SEER	—	10.5	—	11.0	—	10.5
Moisture Removal <i>PL/h(l/h)</i>	2.2 (1.0)	4.4 (2.0)	2.2 (1.0)	4.4 (2.0)	3.2 (1.5)	6.3 (3.0)
Voltage/Frequency/Phase	230/208/60/1	230/208/60/1	230/208/60/1	230/208/60/1	230/208/60/1	230/208/60/1
Recommended Fuse Size <i>#</i>	20	20	20	20	25	25
Air Circ. <i>C.F.M. (m³/h) : Hi</i>	300 (510)	300 (510)	300 (510)	300 (510)	306 (520)	306 (520)
<i>Medium</i>	271 (460)	271 (460)	271 (460)	271 (460)	282 (480)	282 (480)
<i>Low</i>	241 (410)	241 (410)	241 (410)	241 (410)	259 (440)	259 (440)
<i>Quiet</i>	218 (370)	218 (370)	218 (370)	218 (370)	235 (400)	235 (400)
Noise Level <i>dB(A) : Hi</i>	40.0	40.0	40.0	40.0	41.0	41.0
<i>Medium</i>	38.0	38.0	38.0	38.0	39.0	39.0
<i>Low</i>	36.0	36.0	36.0	36.0	37.0	37.0
<i>Quiet</i>	33.0	33.0	33.0	33.0	35.0	35.0
Indoor Fan Speed <i>RPM : Hi</i>	1,320	1,320	1,320	1,320	1,350	1,350
<i>Medium</i>	1,210	1,210	1,210	1,210	1,250	1,250
<i>Low</i>	1,100	1,100	1,100	1,100	1,150	1,150
<i>Quiet</i>	1,000	1,000	1,000	1,000	1,050	1,050
Outdoor Fan Speed <i>RPM</i>	735	735	735	735	735	735
Outdoor Noise Level <i>dB(A)</i>	54.0	54.0	54.0	54.0	54.0	54.0
Current <i>(A) : Cooling</i>	4.9/4.6	9.0/9.5	4.9/4.6	9.0/9.5	5.8/6.3	10.8/12.0
<i>Heating</i>	—	—	4.6/4.4	8.5/8.1	—	—
Power Use <i>(kW) : Cooling</i>	1.03/1.00	2.00/1.95	1.03/1.00	2.00/1.95	1.30/1.30	2.45/2.45
<i>Heating</i>	—	—	0.98/0.94	1.75/1.65	—	—
Fan Speeds <i>Stage</i>	4 + Auto.	4 + Auto.	4 + Auto.	4 + Auto.	4 + Auto.	4 + Auto.
Air Direction : <i>Horizontal</i>	Manual	Manual	Manual	Manual	Manual	Manual
<i>Vertical</i>	Automatic	Automatic	Automatic	Automatic	Automatic	Automatic
Air Filter	Washable	Washable	Washable	Washable	Washable	Washable
Front Grille	Removable	Removable	Removable	Removable	Removable	Removable
Connection Method	Flare	Flare	Flare	Flare	Flare	Flare
Combined Max. Lgth <i>Ft (#)</i>	49 (15) Each	49 (15) Each	49 (15) Each	49 (15) Each	49 (15) Each	49 (15) Each
Max. Vertical Diff. <i>Ft (#)</i>	26 (8) Each	26 (8) Each	26 (8) Each	26 (8) Each	26 (8) Each	26 (8) Each
Conn. Pipe Diameter <i>Inch</i>	Suc. 3/8 Dis. 1/4	Suc. 3/8 Dis. 1/4	Suc. 3/8 Dis. 1/4	Suc. 3/8 Dis. 1/4	Suc. 1/2 Dis. 1/4	Suc. 1/2 Dis. 1/4
Net Weight <i>lbs. (kg)</i>	22 (10)	143 (65)	22 (10)	143 (65)	22 (10)	146 (66)
Dimensions : <i>Height Inch</i>	11	25-3/8	11	25-3/8	11	25-3/8
<i>mm</i>	280	643	280	643	280	643
<i>Width Inch</i>	32-1/8	33	32-1/8	33	32-1/8	33
<i>mm</i>	815	840	815	840	815	840
<i>Depth Inch</i>	7	13	7	13	7	13
<i>mm</i>	179	335	179	335	179	335
	Indoor ASU9DX1	Outdoor AOU18D	Indoor ASU9DX2	Outdoor AOU18	Indoor ASU9RDx1	Outdoor AOU18RD
	Indoor ASU9RDx2	Outdoor AOU18RD	Indoor ASU12D1x1	Outdoor AOU24D1	Indoor ASU12D1x2	Outdoor AOU24D1

Additional detail on page 15.



Tri-Zone System

By offering a large 3-ton “tri-zone” system, Fujitsu multi-zone products now encompass a myriad of possible applications for use in town-homes, strip malls, private offices, and other large or divided spaces. Independent circuits assure more specific controls for environments both large and small, with generous standard features.

ADDITIONAL AND EXCEPTIONAL FEATURES

- **Independent Operation:** This tri-zone system enables the user to modify three environmental zones independently or simultaneously.
- **Auto Louver Function:** By redirecting airflow automatically, cooling large areas efficiently is simplified. The two smaller units use a 7-stage up/down motion. The larger unit has a 4-way directional air sweep.

TRI-ZONE AIR CONDITIONING SYSTEM 36CT



TRI-ZONE APPLICATIONS

By strategically placing the three air handlers where air flow is maximized, a more extensive area may be cooled. You can also choose to cool only certain zones that are in use, thanks to independent controls. For the ultimate in quiet operation, and for energy conscious users, the tri-zone is the perfect solution.

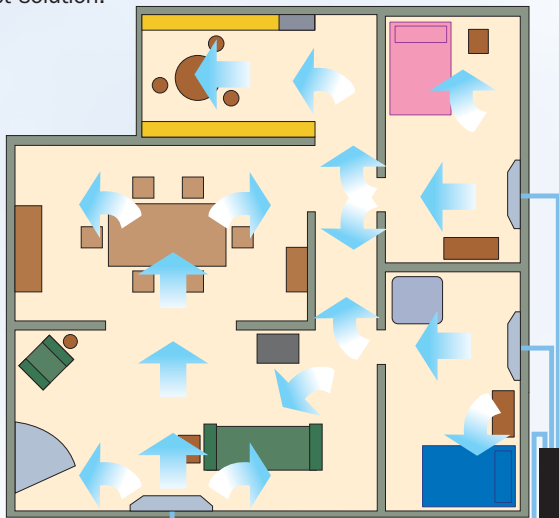

TRI-ZONE

36CT

Nominal Cooling <i>BTU/h</i>	12,000/11,500	18,000/17,500	
<i>Unit A+B BTU/h</i>	18,000/17,500		
Nominal Heating <i>BTU/h</i>	—	—	
HSPF <i>BTU/hW</i>	—	—	
SEER	—	11.0	
Moisture Removal <i>Pt./%l/h</i>	3.4 (1.6)	4.26 (2.0)	
Voltage/Frequency/Phase	230-208/60/1	230-208/60/1	
Recommended Fuse Size <i>#</i>	25	25	
Air Circ. <i>C.F.M. (m³/h) : Hi</i>	312 (530)	471 (800)	
<i>Medium</i>	283 (480)	412 (700)	
<i>Low</i>	260 (440)	347 (590)	
<i>Quiet</i>	230 (390)	—	
Noise Level <i>dB(A) : Hi</i>	42.0	43.0	
<i>Medium</i>	40.0	40.0	
<i>Low</i>	38.0	37.0	
<i>Quiet</i>	35.0	—	
Indoor Fan Speed <i>RPM : Hi</i>	1,350	1,150	
<i>Medium</i>	1,250	1,000	
<i>Low</i>	1,150	850	
<i>Quiet</i>	1,050	—	
Outdoor Fan Speed <i>RPM</i>	790	790	
Outdoor Noise Level <i>dB(A)</i>	58.0	58.0	
Current <i>(A) : Cooling</i>	8.0/8.3	9.3/9.8	
<i>Heating</i>	—	—	
Power Use <i>(kw) : Cooling</i>	1.81/1.73	2.14/2.06	
<i>Heating</i>	—	—	
Fan Speeds <i>stage</i>	4 + Auto.	3 + Auto.	
Air Direction : <i>Horizontal</i>	Manual	Automatic	
<i>Vertical</i>	Automatic	Automatic	
Air Filter	Washable	Washable	
Front Grille	Removable	Removable	
Connection Method	Flare	Flare	
Combined Max. Lgth <i>Ft ft</i>	49 (15) Each	65 (20) Each	
Max. Vertical Diff. <i>Ft ft</i>	26 (8) Each	26 (8) Each	
Conn. Pipe Diameter <i>Inch</i>	Suc. 1/2 Dis. 1/4	Suc. 1/2 Dis. 1/4	
Net Weight <i>lbs. (kg)</i>	22 (10)	40 (18)	220 (100)
Dimensions : <i>Height Inch</i>	11	12-19/32	45-11/32
<i>mm</i>	280	320	1,152
<i>Width Inch</i>	32-1/8	49-7/32	37
<i>mm</i>	815	1,250	940
<i>Depth Inch</i>	7	7-11/16	14-9/16
<i>mm</i>	179	195	370
Unit A ASU9T	Unit AB ASU9T	Unit C ASU18T	Outdoor AOU36T

Additional detail on page 15.

Universal / Ceiling Suspended Systems

Fujitsu has an attractive way to accommodate “difficult to cool” indoor areas with a slim line “universal” system that can be suspended from the ceiling, placed low on the wall or rested on the floor. For large areas, when floor and wall space is restricted, Fujitsu has a larger ceiling suspended system that can be “partially recessed”. All systems can access “fresh air”, and come with “energy saver mode” and “auto restart” functions (see features chart on page 15).

ADDITIONAL AND EXCEPTIONAL FEATURES

- **Unique 3 in 1 Flexibility:** The user has the option of installing our System 22U either on the floor, wall, or ceiling depending on the desired or necessary installation requirement.
- **Double Auto Louver:** All systems have horizontal and vertical automated air sweeps that are operable from the remote control. You can also choose varying degrees of air flow angles.
- **Sleep Function:** This feature automatically adjusts the temperature while you sleep to make you more comfortable.
- **Dry Mode:** This setting helps to control humidity levels when cooling may not be needed.

UNIVERSAL SYSTEM 22U



CEILING MOUNT SYSTEM 36CS



UNIVERSAL / CEILING

	22U	36CS		
Nominal Cooling <i>BTU/h</i>	21,000/20,500	36,500/35,500		
Nominal Heating <i>BTU/h</i>	—	—		
HSPF <i>BTU/hW</i>	—	—		
SEER	10.0	10.0		
Moisture Removal <i>Pt./h(l/h)</i>	5.3 (2.5)	8.7/8.5 (4.1/4.0)		
Voltage/Frequency/Phase	230/208/60/1	230/208/60/1		
Recommended Fuse Size <i>#</i>	20	30		
Air Circ. <i>c.F.M. (m³/h) : Hi</i>	530 (900)	1,236 (2,100)		
<i>Medium</i>	460 (780)	1,130 (1,920)		
<i>Low</i>	389 (660)	977 (1,660)		
<i>Quiet</i>	—	—		
Noise Level <i>dB(A) : Hi</i>	49.0	51.0		
<i>Medium</i>	45.0	49.0		
<i>Low</i>	41.0	45.0		
<i>Quiet</i>	—	—		
Indoor Fan Speed <i>RPM : Hi</i>	1,200	1,250		
<i>Medium</i>	1,030	1,150		
<i>Low</i>	910	1,000		
<i>Quiet</i>	—	—		
Outdoor Fan Speed <i>RPM</i>	760	790		
Outdoor Noise Level <i>dB(A)</i>	56.0	59.0		
Current <i>(A) : Cooling</i>	9.6/10.4	18.5/19.5		
<i>Heating</i>	—	—		
Power Use <i>(kW) : Cooling</i>	2.18/2.14	3.85/3.8		
<i>Heating</i>	—	—		
Fan Speeds <i>Stage</i>	3 + Auto.	3 + Auto.		
Air Direction : <i>Horizontal</i>	Automatic	Automatic		
<i>Vertical</i>	Automatic	Automatic		
Air Filter	Washable	Washable		
Front Grille	Permanent	Permanent		
Connection Method	Flare	Flare		
Combined Max. Lgth <i>Ft #</i>	85 (27)	164 (50)		
Max. Vertical Diff. <i>Ft #</i>	36 (11)	99 (30)		
Conn. Pipe Diameter <i>Inch</i>	Suc. 5/8 Dis. 3/8	Suc. 3/4 Dis. 3/8		
Net Weight <i>lbs. (kg)</i>	66 (30) 147 (68)	106 (48) 223 (101)		
Dimensions : <i>Height Inch</i>	7-3/4 25-5/16	9-7/16 45-11/32		
<i>mm</i>	199 643	240 1,152		
<i>Width Inch</i>	38-31/32 33-1/16	65-11/32 37		
<i>mm</i>	990 840	1,660 940		
<i>Depth Inch</i>	25-25/32 13-7/32	27-9/16 14-9/16		
<i>mm</i>	655 336	700 370		
	Indoor ABU22	Outdoor AOU22	Indoor ABU36	Outdoor AOU36

Additional detail on page 15.



Ceiling Cassette Systems

Fujitsu has added to its line of ceiling cassette systems. The new ceiling 36RC and 42RC cassettes add a new dimension to the already sleek line of cassettes. Mounting flush with a suspended ceiling our 18RC and 24RC cassettes can recess above with a clearance of just 9-1/4 inches. The new slender fit feature offered on the 36RC and 42RC allows the cassette to be recessed in as little as 9-7/8 inches making them one of the slimmest cassettes available. Couple that with advanced design features like: fresh air intake, a built in condensate pump, available branch ducts and automatic change-over from cooling to heating. Now you have Fujitsu innovation and quality.

ADDITIONAL AND EXCEPTIONAL FEATURES

- **Fresh Air Intake:** A knock-out is provided so you can bring in fresh outside air for a healthier environment.
- **Condensate Pump:** Built in condensate pump allows for drainage from the unit up to 31-1/2" allowing condensate to then be drained by gravity to another point.
- **Branch Ducts:** These recessed ceiling systems come with 2 branch ducts providing cooling access to smaller rooms; such as bathrooms, closets, etc.

CEILING CASSETTE SYSTEMS 18RC, 24RC, 36RC, AND 42RC



SYSTEM APPLICATIONS



Wired Controller

- Weekly timer
- Set on-off time twice a day
- Set different on-off time by day
- Set time in 5 minute intervals
- Control up to 16 indoor units

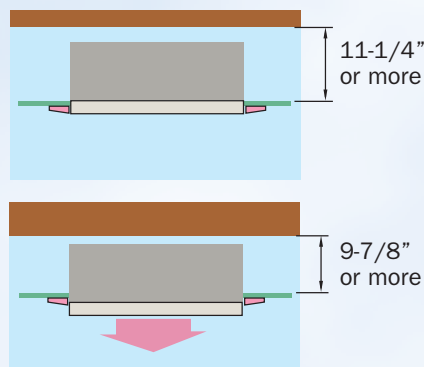

Slender Fit, 36/42

Cassette body can be moved downward into the room 1-3/8" to accommodate limited ceiling space.

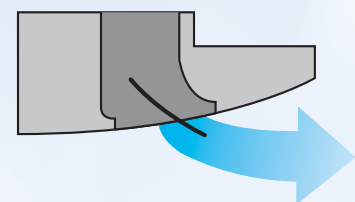

Wide Air Flow

Large louvers distribute the air flow further into the room. Auto swing louvers help circulate air more evenly at all levels.



CEILING CASSETTE SYSTEMS

	18RC	24RC	36RC	42RC
Nominal Cooling <i>BTU/h</i>	18,000/17,000	23,500/22,500	36,000/35,500	42,000/40,000
Nominal Heating <i>BTU/h</i>	18,500/18,000	24,000/23,000	43,000/42,000	48,000/46,000
HSPF <i>BTU/hW</i>	7.0	7.1	7.4	7.4
SEER	10.5	10.5	10.5	10.5
Moisture Removal <i>Pt. h(l/h)</i>	3.8 (1.8)	5.7 (2.7)	8.7 (4.1)	11.5 (5.4)
Voltage/Frequency/Phase	230-208/60/1	230-208/60/1	230-208/60/1	230-208/60/1
Recommended Fuse Size <i>#</i>	20	20	35	40
Air Circ. <i>c.F.M. (m³/h) : Hi</i>	541 (920)	647 (1,100)	1000 (1700)	1011 (1720)
<i>Medium</i>	471 (800)	553 (940)	912 (1550)	924 (1570)
<i>Low</i>	400 (680)	459 (780)	794 (1350)	824 (1400)
<i>Quiet</i>	—	—	—	—
Noise Level <i>dB(A) : Hi</i>	41.0	44.0	50.0	50.5
<i>Medium</i>	37.0	42.0	48.0	48.5
<i>Low</i>	35.0	39.0	45.0	46.0
<i>Quiet</i>	—	—	—	—
Indoor Fan Speed <i>RPM : Hi</i>	420	490	650	660
<i>Medium</i>	370	430	590	600
<i>Low</i>	330	360	520	540
<i>Quiet</i>	—	—	—	—
Outdoor Fan Speed <i>RPM</i>	735	735	790	790
Outdoor Noise Level <i>dB(A)</i>	57.0	57.0	59.0	59.0
Current <i>(A) : Cooling</i>	8.5/9.0	10.5/11.2	16.0/17.0	19.5/21.0
<i>Heating</i>	7.7/8.1	9.5/10.2	18.0/19.5	21.0/23.0
Power Use <i>(kw) : Cooling</i>	1.90/1.83	2.35/2.30	3.55/3.50	4.35/4.28
<i>Heating</i>	1.72/1.66	2.10/2.05	3.95/3.90	4.75/4.68
Fan Speeds <i>Stage</i>	3 + Auto.	3 + Auto.	3 + Auto.	3 + Auto.
Air Direction : <i>Horizontal</i>	—	—	—	—
<i>Vertical</i>	Automatic	Automatic	Automatic	Automatic
Air Filter	Washable	Washable	Washable	Washable
Front Grille	Removable	Removable	Permanent	Permanent
Connection Method	Flare	Flare	Flare	Flare
Combined Max. Lgth <i>Ft #</i>	82 (25) Each	82 (25) Each	164 (50) Each	164 (50) Each
Max. Vertical Diff. <i>Ft #</i>	49 (15) Each	49 (15) Each	99 (30) Each	99 (30) Each
Conn. Pipe Diameter <i>Inch</i>	Suc. 5/8 Dis. 3/8	Suc. 5/8 Dis. 3/8	Suc. 3/4 Dis. 3/8	Suc. 3/4 Dis. 3/8
Net Weight <i>lbs. (kg)</i>	75 (34)	147 (67)	75 (34)	150 (68)
	88 (40)	220 (100)	88 (40)	243 (110)
Dimensions : <i>Height Inch</i>	9-11/16	25-3/8	9-11/16	25-3/8
<i>mm</i>	246	643	246	643
<i>mm</i>	296	1152	296	1152
<i>Width Inch</i>	32-11/16	33	32-11/16	33
<i>mm</i>	830	840	830	840
<i>mm</i>	830	940	830	940
<i>Depth Inch</i>	32-11/16	13-7/32	32-11/16	13-7/32
<i>mm</i>	830	336	830	336
<i>mm</i>	830	370	830	370
	Indoor AUU18RC	Outdoor AOU18RC	Indoor AUU24RC	Outdoor AOU24RC
	Indoor AUU36RC	Outdoor AOU36RC	Indoor AUU42RC	Outdoor AOU42RC

Additional detail on page 15.

Power Diffuser & Air Flow

The Fujitsu *Power Diffuser* automatically opens when the louvers are directed to their fullest position. In the heating mode, warm air is forced directly to the floor where it can then rise to provide even heating. During cooling, cold air is directed overhead to the warmest area and then naturally moves downward to provide even cooling. The louvers are aerodynamically engineered to boost air flow and reduce noise.

VERTICAL HEATING AIR FLOW

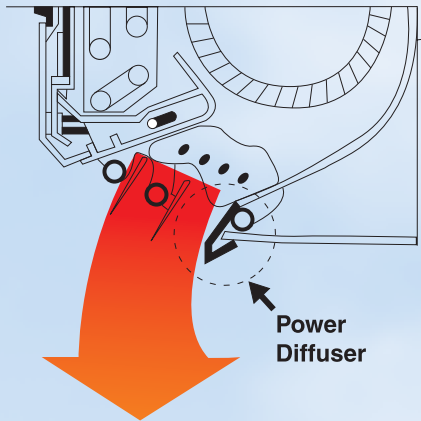

HORIZONTAL COOLING AIR FLOW

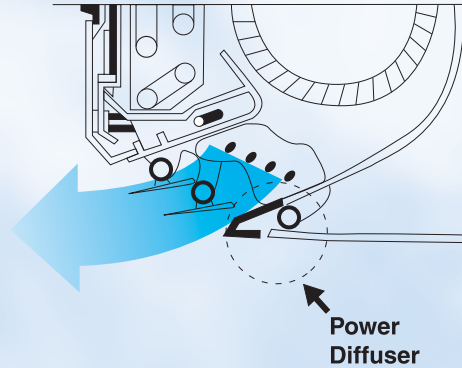

Digital Wireless Remotes

SMALL SYSTEM CONTROL 9 AND 12

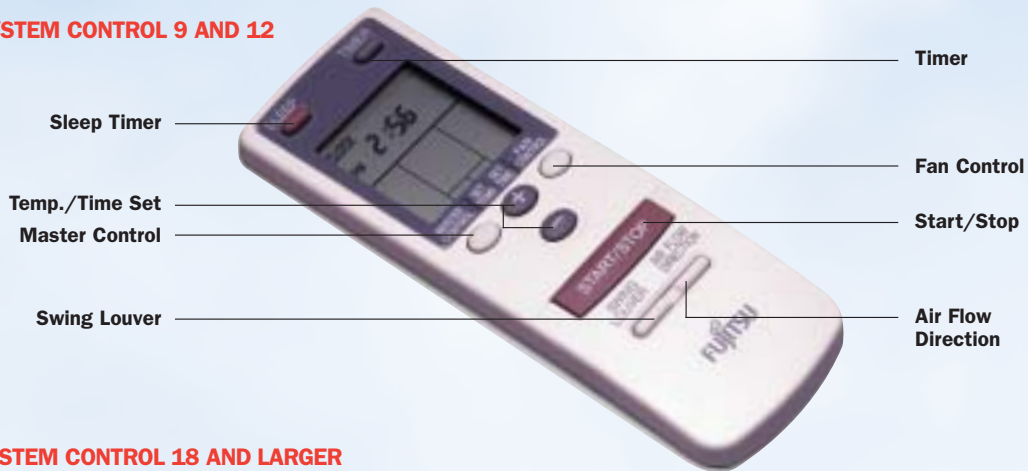

LARGE SYSTEM CONTROL 18 AND LARGER

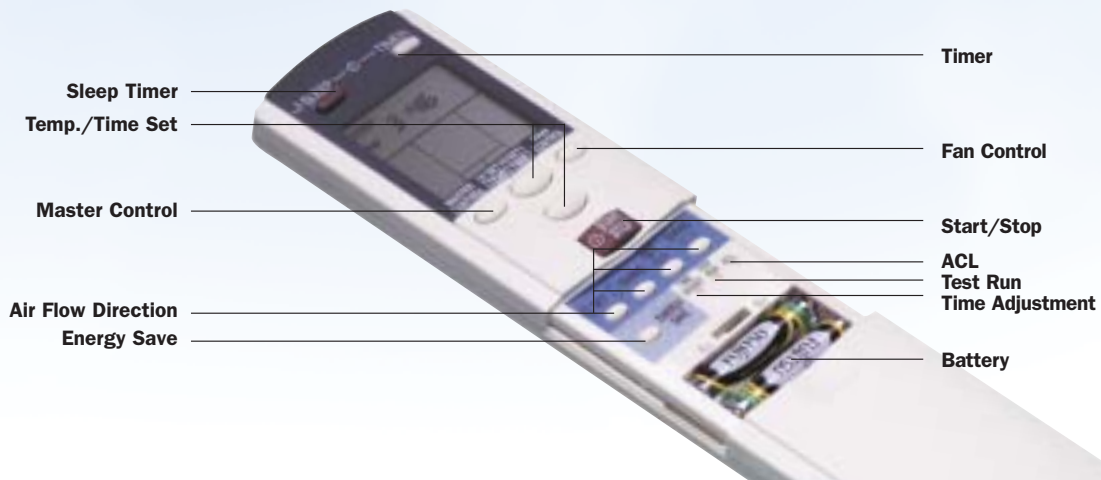

MODEL FEATURE CHART

	9C1	9R1A	12C1	12R1A	18C1	18R1	24C1	24R1	30C1	22U	36CS	24CD1	18CD	18RD	18RC	24RC	36RC	42RC	36CT	
Sleep Timer	✓	✓	✓	✓	✓	✓	✓	✓	✓	✓	✓	✓	✓	✓						✓
24 HR. Timer	✓	✓	✓	✓	✓	✓	✓	✓	✓	✓	✓	✓	✓	✓	✓	✓	✓	✓	✓	✓
Weekly Timer															✓	✓	✓	✓		
Dry Mode	✓	✓	✓	✓	✓	✓	✓	✓	✓	✓	✓	✓	✓	✓	✓	✓	✓	✓	✓	✓
Auto/Louver Up/Down	✓	✓	✓	✓	✓	✓	✓	✓	✓	✓	✓	✓	✓	✓	✓	✓	✓	✓	✓	✓
Auto Louver 4 Way					✓	✓	✓	✓	✓	✓	✓									✓
Energy Saver					✓	✓	✓	✓	✓	✓	✓			✓	✓	✓	✓	✓	✓	✓
Quiet Mode	✓	✓	✓	✓								✓	✓	✓						✓
Power Diffuser	✓	✓	✓	✓	✓	✓	✓	✓	✓			✓	✓	✓						✓
Super Vane					✓	✓	✓	✓	✓	✓	✓									✓
Auto Restart	✓	✓	✓	✓	✓	✓	✓	✓	✓	✓	✓	✓	✓	✓	✓	✓	✓	✓	✓	✓
Auto Reset	✓	✓	✓	✓	✓	✓	✓	✓	✓	✓	✓	✓	✓	✓	✓	✓	✓	✓	✓	✓
Auto Changeover		✓		✓		✓		✓						✓	✓	✓	✓	✓	✓	
Low Ambient	✓	✓	✓	✓	✓	✓	✓	✓	✓		✓	✓	✓	✓	✓	✓	✓	✓	✓	✓
Cold Prevention		✓		✓		✓		✓						✓	✓	✓	✓	✓	✓	
Slender Fit																	✓	✓		

BTU Rating	Square Footage
9,000 - 12,000	350 - 675
18,000 - 24,000	700 - 1,350
30,000	1,200 - 1,700
36,000 - 42,000	1,500 - 2,375

Estimated square footages may be more, or less depending upon ceiling height, insulation, building materials, climate zones, and other factors affecting "heat loads" such as appliances, window area, and electronics. Figures used in this catalog supercede all other previous references.

Consult your engineer or HVAC professional.

Accessories and Recommendations

Supplemental Air Filter: Three stage air filter includes Activated charcoal filter which helps to remove odors, an Electrostatic type filter removes more particulate dust, and a Pleated filter to remove extra fine particles. Available for all wall mount systems.

Condensate Pumps: Fujitsu condensate pump is available for System 36CS. All other models can be fitted with a Micro-pump, field supplied.

Low Ambient Control: All Fujitsu systems are capable of operating in ambient conditions down to 32°F. If operation below 32°F is required a field installed low ambient kit must be installed, field supplied.

For more information, contact your local representative or distributor; or contact Fujitsu General America, Inc.

Complete System Warranty

- 1 Year – Parts
- 5 Years – Compressor

- NOTE: Condensing units come pre-charged from factory. Additional refrigerant may be required, be sure to check installation manual for more details.
- Cooling capacity is based on the following conditions.
Indoor temperature: 80°F DB/67°F WB (26.7°C DB/19.4°C WB)
Outdoor temperature: 95°F DB/75°F WB (35°C DB/23.9°C WB)
- Heating capacity is based on the following conditions.
Indoor temperature: 70°F DB (21.1°C DB)
Outdoor temperature: 47°F DB/43°F WB (8.3°C DB/6.1°C WB)
- Specifications and design are subject to change without notice for further improvement.

- ISO 9002
- ISO 14001





Engineering Solutions
 Halcyon goes where ducts can't.

Architectural Freedom
 Open, airy designs not a problem with Halcyon ductless mini-splits.

Cost Savings
 Ease of installation saves time and money.

COMFORT BY DESIGN



For 30 years we've been working hard to make the world a more comfortable place.

We've produced and shipped millions of air conditioning systems all over the world to make the hottest places cool and the coolest places comfortable.



Floor level heating
 When required, the power diffuser automatically opens, concentrating airflow down to the floor level.

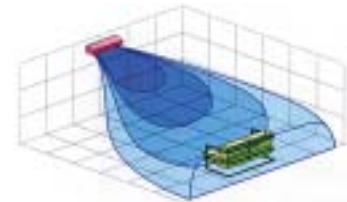

Large, wide airflow
 Large louvers distribute airflow further into the room. Auto-Swing movement helps circulate air more evenly at all levels.

Distributed by:

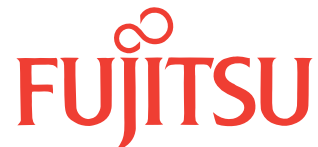

Fujitsu General America, Inc.
 353 Route 46 W., Fairfield, NJ 07004
 Tel. (973) 575-0380 Fax. (973) 575-7509
 E-Mail Address: fghvac@fujitsugeneral.com
 www.fujitsugeneral.com

A subsidiary of
 Fujitsu General Limited